

Epon user terminal device optical signal red light



Overview

If LOS is red, there's an issue with the optical signal; contact your service provider. This user manual provides comprehensive instructions for the installation, operation, maintenance, and troubleshooting of the HG8245C XPON/EPON Optical Network Terminal (ONT). The HG8245C is a high-performance device designed to provide broadband access, voice, and Wi-Fi services to home and small. It acts as the essential bridge, converting the high-speed fiber optic signal coming into your home or business into a format that your everyday devices can understand. This. PON (Passive Optical Network), as an access network technology, can implement fiber optic to the home, satisfying the high-bandwidth requirement of the "last kilometer" in the access layer network. □□ Future Updates. The unit connects to any network it finds, recognizes the type of network and performs tests using built-in thresholds that follow IEEE protocols and standards. Starting/stopping/restarting measurements from the OPM menu (see OLT Information Table) starts/stops/resets items in the OPM Summary. 1 Note 1. 1 Installation Precautions □ Do not near flammable or conductive items, high temperature, direct sunlight or moist environment, or on PC chassis, and check whether

other home equipment placed around stability □ Check the cable line.

Epon user terminal device optical signal red light

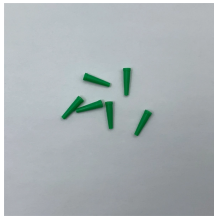

Warning: Never look directly into the beam of an active optical source as this may result in harmful eye damage from radiation exposure.



dband, CATV dual network integration. It is based on mature and stable, cost-effective Gigabit EPON technology and integrate Gigabit Ethernet switching technology, WDM technology and HFC light ...



If the optical path is not working, you need to see if there is a large bend in the fiber; or see if the end of the fiber is not connected somewhere. If you can not get it, you can contact the ...



When the PON port is disabled, there is no optical signal, which is one of the signs indicating this issue. It is necessary to check the status of the PON port on the OLT, and if that is the case, enable the ...



· The Optical Line Terminal (OLT) is the core device of the PON system, usually placed in the central machine room. It is used for the unified management of the ONU and converges and ...

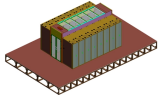

An ONU (Optical Network Unit) is a device located at the end-user's premises in a passive optical network (PON). Its primary function is to terminate the fiber optic line, convert the optical signal ...



The document provides instructions for installing and using an EPON/GPON ONU device. It includes:
- A list of items in the product package and descriptions of the front and back panels.



View and Download Zte EPON SFU Series user manual online. 1GE/1GE+CATV. EPON SFU Series network hardware pdf manual download.

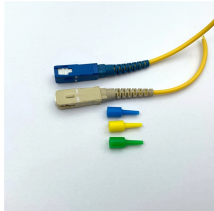

It contains configuration commands, troubleshooting methods, power-check commands, and best practices for multiple OLT brands. Whether you're managing a large ISP or setting up a lab, ...

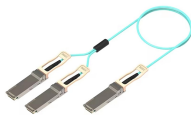

If LOS is red, there's an issue with the optical signal; contact your service provider. Cable Connections: Verify all cables (fiber, Ethernet) are securely connected.

Contact Us

For more information, pricing, or custom energy solutions, please contact us:

Website: <https://www.gdroofing.co.za>

Email: sales@gdroofing.co.za

Phone: +27 72 418 9365

Address: 22 Electron Avenue, Isando, Johannesburg, 1600, South Africa

This document is for informational purposes only. Specifications subject to change without notice.

