

Installation of electrical distribution boxes at field construction sites



Installation of electrical distribution boxes at field construction site



Discover how to supply temporary power safely on construction sites using E-abel distribution boxes, industrial plug sockets, and IP67 connectors for reliable outdoor electricity.



work requires electrical power for many purposes. However, exposure to weather, frequent relocation, rough use and other conditions not normally encountered with conventional wiring systems ...

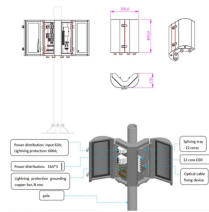

Whether you are an electrical contractor or a construction brigade, knowing how to properly and safely install distribution boxes is the basis of ensuring the safe operation of the entire ...



Every year, the use of electricity on construction sites results in accidents from electric shock and burns which can be serious or even fatal. This article will consider the various regulations ...



Temporary Power Regulations in Construction This document discusses requirements for installing temporary power at construction sites according to OSHA, NFPA, NECA, and product standards.



In this video we are showing a complete Construction Site Electrical Distribution Panel setup. This includes MCCB, MCB, DB boxes, cable management, earthing and load distribution for...

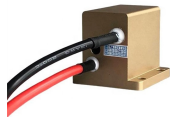

The precise process for installing electrical systems in warehouses and factories according to standards and the key points to note. Learn how to efficiently install electrical systems ...



Standardized guidance has been prepared to assist engineers with unique installation requirements. Exterior electrical equipment design criteria are specified to ensure that a reliable installation is realized.



Ensure safety on construction sites with our guide on Temporary Electrical Installations. Get practical tips and advice on implementing effective safety measures today!

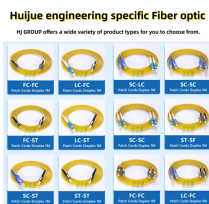

Learn how to install a distribution box safely and correctly. Covers wiring, placement, standards, and expert tips for a compliant setup.

Contact Us

For more information, pricing, or custom energy solutions, please contact us:

Website: <https://www.gdroofing.co.za>

Email: sales@gdroofing.co.za

Phone: +27 72 418 9365

Address: 22 Electron Avenue, Isando, Johannesburg, 1600, South Africa

This document is for informational purposes only. Specifications subject to change without notice.

