

On-site commissioning of the distribution box

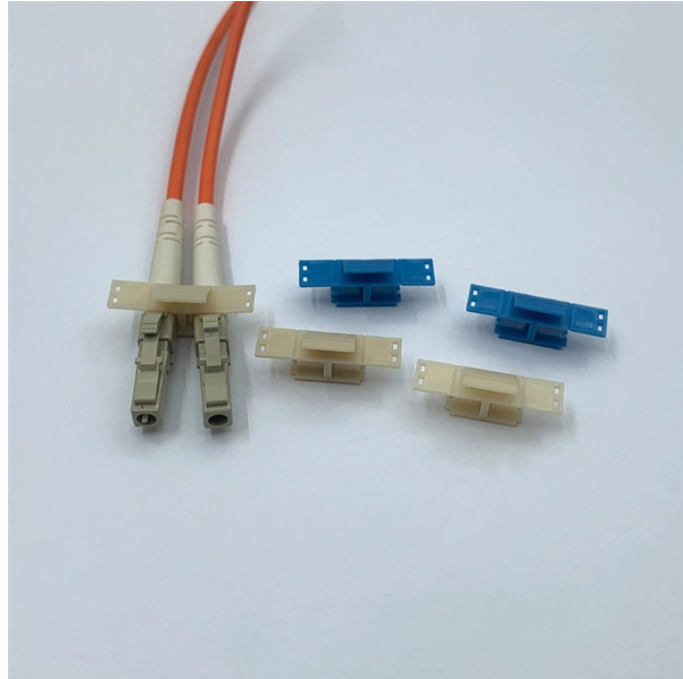

On-site commissioning of the distribution box



2.1 This method statement will cover the testing & pre-commissioning of Control, Distribution and Misc. Panel (Lighting, Power, etc) and carry out all the applicable tests for REFINERY and Plants.

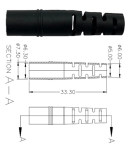

The purpose of this method statement procedure is to define the step by step method to guide & implement the correct practices for the precommissioning & ...



This post is supposed to provide distribution panel testing and execute commissioning while the inspection checklist is being completed.

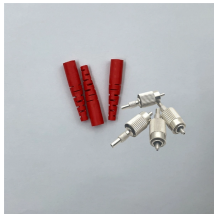

The site testing and commissioning of a transmission or distribution plant are the final procedures conducted to verify the ...

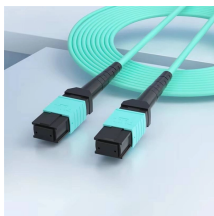

All Safety Regulations and requirements as per the project approved EHSP plan must be implemented and monitored on site at all times by electrical staff. Safety induction and training to all involved site ...



TARGET AUDIENCE Engineering and technical staff involved in the installation, commissioning, operation and maintenance of distribution switchgear



Installation completed per design drawings. Manufacturer submittals reviewed and approved. Conduits, cables, and terminations inspected. Panelboard, switchgear, and transformer locations verified. ...



METHOD STATEMENT FOR Electric panel and distribution box installation and termination - Free download as PDF File (.pdf), Text File (.txt) or read online for free. This document provides a method ...



The purpose of this method statement procedure is to define the step by step method to guide & implement the correct practices for the precommissioning & commissioning of Distribution Boards or ...



Learn how to wire a distribution box step by step! This video shows real on-site footage of electrical installation, demonstrating safe and standardized wiring methods used by professionals.



Earth fault loop impedance test & earth leakage test for LV Distribution Board shall be done & recorded in prescribed format. There are 3 cases to be considered.



The site testing and commissioning of a transmission or distribution plant are the final procedures conducted to verify the proper functioning of the plant and its compliance with stated ...

Contact Us

For more information, pricing, or custom energy solutions, please contact us:

Website: <https://www.gdroofing.co.za>

Email: sales@gdroofing.co.za

Phone: +27 72 418 9365

Address: 22 Electron Avenue, Isando, Johannesburg, 1600, South Africa

This document is for informational purposes only. Specifications subject to change without notice.

