

## Rail-mounted optical switch



## Rail-mounted optical switch



FS DIN rail-mounted industrial switches feature IP41 dust and waterproof protection. These industrial Ethernet switches ensure reliable connectivity with their high-performance, compact, and durable ...



The IBP-202 Optical Bypass Switch is an industrial grade external bypass switch for optical-node failure in fiber optical network infrastructure. The IBP-202 Optical Bypass Switch prevents and saves ...



Lfiber's rackmount fiber optic switch functions by selectively switching a light signal delivered through an optical fiber or an integrated optical circuit to another. In essence, the switch is the control for ...



This industrial switch with a fiber port provides a reliable, high-speed connection for long-distance applications. The industrial design makes it ideal for the harshest networking environments.



The NT402-1P is a 3-port Gigabit Ethernet switch with 2-port 10/100/1000Base-T (X) and 1-port 100/1000Base-X SFP slot for optical fiber providing stable and reliable transmission for Industrial ...

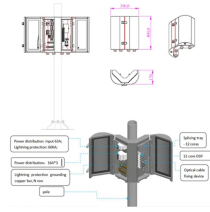

Choose from our selection of fiber optic ethernet switches, including DIN-rail mount ethernet switches, light duty ethernet switches, and more. Same and Next Day Delivery.



The industrial Bypass mechanical optical switch's 4KV power port surge protection can adapt to harsh outdoor environments and ensure the reliability of the uninterrupted network system.



This industrial Ethernet switch is a small form factor and efficient Industrial Ethernet solution with integrated serial server or Ethernet card expandability. Compact Chassis with Full Management



The NT402-1P is a 3-port Gigabit Ethernet switch with 2-port 10/100/1000Base-T ...



Our Industrial Ethernet Switch portfolio comprises Managed and Unmanaged Switches with Gigabit, PoE, IEC 61850 certification, and for DIN rail mounting.



1.Dual Gigabit & Fiber Integration 2 x 10/100/1000Mbps Ethernet ports plus 100/1000Base-X fiber converter enable seamless copper/fiber transmission. Auto-sensing adapts to 10/100/1000Mbps ...

## Contact Us

For more information, pricing, or custom energy solutions, please contact us:

Website: <https://www.gdroofing.co.za>

Email: [sales@gdroofing.co.za](mailto:sales@gdroofing.co.za)

Phone: +27 72 418 9365

Address: 22 Electron Avenue, Isando, Johannesburg, 1600, South Africa

This document is for informational purposes only. Specifications subject to change without notice.

