

Telecom Shelter 19-inch CE Certification

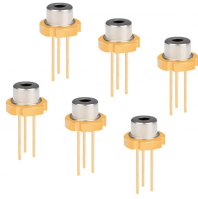

Telecom Shelter 19-inch CE Certification



U.S.-made telecom enclosures, NEMA cabinets, and outdoor shelters since 1989. BABA-compliant solutions for telecom, energy, and data centers.



Shelter Works engineered-to-order telecom shelters are the perfect solution for protecting critical field equipment. Our shelters, manufactured with our exclusive FiberBeam™ Technology, are lightweight, ...



Telhua's 19-inch outdoor telecom enclosure delivers IP68 protection, high fiber ...

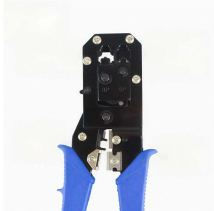

A: We have passed the quality certification CE and ROHS, and there are quality inspectors, which are produced in strict accordance with international standards.



AZE's NEMA 4/4X certified HVAC outdoor telecom enclosures deliver industrial-grade climate control for critical infrastructure. Our temperature-regulated electrical cabinets protect 19" server racks, fiber ...



Telhua's 19-inch outdoor telecom enclosure delivers IP68 protection, high fiber density, and rapid deployment for B2B fiber optic networks. IEC/TIA/EIA compliant with RoHS certification.



Delvalle manufactures custom outdoor telecom racks with standard pricing and industrial-grade quality. Specially designed for the telecommunications industry, these enclosures feature double-walled ...

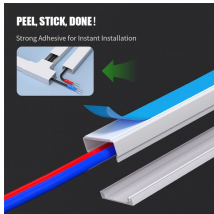

Providing Communication Shelters for Decades, and Federal and state agencies. We offer lightweight and concrete solutions for your equipment shelter needs. Factory fabricated, Thermo Bond provides ...



Our outdoor telecom cabinets and outdoor telecom enclosures are designed to house and protect telecommunications equipment in remote or exposed locations. Features include robust construction, ...



We specialize in constructing resilient communication shelters that optimize your telecom projects. Our secure communication buildings come in various sizes to accommodate your project scope. Simply ...



These lightweight modular shelters are ideal for rooftop and remote locations, and their factory test assembly ensures easy and trouble-free field assembly. Shipped in knock-down configuration, they ...

Contact Us

For more information, pricing, or custom energy solutions, please contact us:

Website: <https://www.gdroofing.co.za>

Email: sales@gdroofing.co.za

Phone: +27 72 418 9365

Address: 22 Electron Avenue, Isando, Johannesburg, 1600, South Africa

This document is for informational purposes only. Specifications subject to change without notice.

